

KEY:

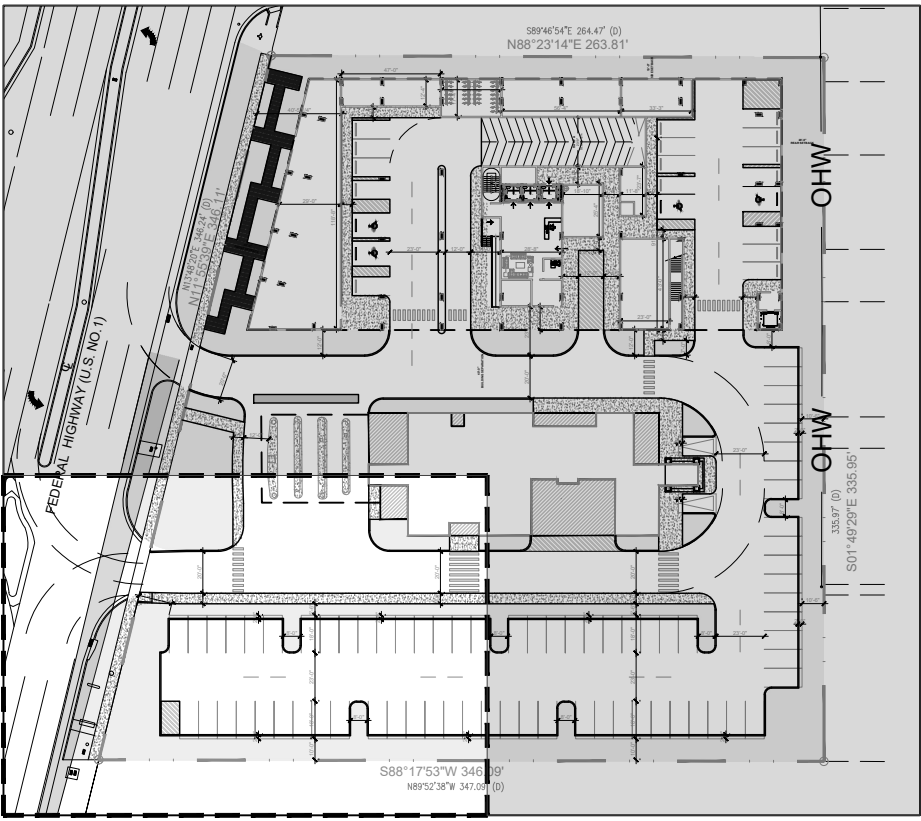

IRRIGATION MATERIALS LIST

| KEY | ITEM | QTY. |
|-----|---|-------------|
| | PVC laterals shall be Class 200 PVC (sized as shown on plans) | as required |
| | MAIN shall be Class 200 PVC | as required |
| | Bubbler Zone Piping | as required |
| | PVC sleeves shall be Class 200 PVC (sized double the width of the pipe within, installed wherever pipe runs under hardscape) | as required |
| | Flexible PVC or Polypipe (for swing joints) | as required |
| WM | Water Meter and Backflow Prevention Assembly (See Civil Plans) | 1 |
| EC | Electric Controller RAINBIRD ESP Series Controller | 1 |
| Δ | Rainbird RSD Series Rain Sensor (locate in area of free rainfall) | 1 |
| ⬢ | RAINBIRD 200-PESB 2" Electromechanical Solenoid Control Valve | # |
| | Irrigation Control Wire | as required |
| ▼ | Rainbird 1" Inline Pressure Regulator (PSI-M40X-100)(drip zones not to exceed 40psi max) | as required |
| | RAINBIRD XFS Subsurface Dripperline XFS-09-12-500/250/100 Air/Vacuum Relief Valves Kit (3/4" Air relief valve/ Easy Fit Compression Tee/ and Flush Cap) | as required |
| ⊠ | Commercial Wide Flow Control Zone Kit (KCZ-100-PRB-LC) (0.3-20 gpm) | as required |
| ⌘ | RAINBIRD 3-RC Quick Coupler Valve | as required |
| ≡≡ | PVC Supply Header for dripperline Class 200 PVC | as required |
| ⊗ | RAINBIRD Xeri-Bubbler UXB-360-1032 (.6 gpm) | as required |
| Δ | RAINBIRD Xeri-Spray Adjustable mister 360 ADJUST (.1 gpm) (install into dripline with Xeri-bug drip emitters for spray into bromeliad cups) | as required |
| ★ | RAINBIRD 1300A-F Adjustable Flood Bubbler 1300A-F (1.5 gpm) | as required |
| | RAINBIRD Rotary Spray Heads 17'-24' radius R-VAN 24 Series @ 40 PSI 6" pop-up in grass areas 12" pop-up on risers in shrub beds | as required |
| ⊗ | 24-360 (3.13 gpm) | |
| ⊗ | 24 (27∘) (2.31 gpm) | |
| ⊗ | 24 (18∘) (1.54 gpm) | |
| ⊗ | 24 (12∘) (1.0 gpm) | |
| ⊗ | 24 (9∘) (.77 gpm) | |
| | RAINBIRD Rotary Spray Heads 13'-18' radius R-VAN 18 Series @ 40 PSI 6" pop-up in grass areas 12" pop-up on risers in shrub beds | as required |
| ● | 18-360 (1.8 gpm) | |
| ● | 18 (27∘) (1.42 gpm) | |
| ● | 18-(18∘) (.98 gpm) | |
| ● | 18-(12∘) (.6 gpm) | |
| ● | 18-(9∘) (.5 gpm) | |
| | RAINBIRD Rotary Spray Heads 8'-14' radius R-VAN 14 Series @ 40 PSI 6" pop-up in grass areas 12" pop-up on risers in shrub beds | |
| ⊗ | 14-360 (1.22 gpm) | |
| ⊗ | 14 (27∘) (.92 gpm) | |
| ⊗ | 14-(18∘) (.61 gpm) | |
| ⊗ | 14-(12∘) (.4 gpm) | |
| ⊗ | 14-(9∘) (.31 gpm) | |

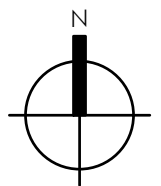

IRRIGATION PLAN - GROUND FLOOR

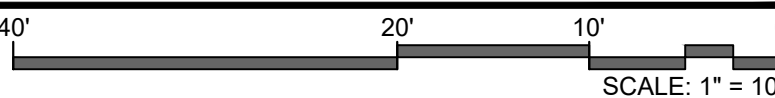

1/303



absolute-idea.com

CANAL PARK
3323 NE 163rd Street, Suite 200 North Miami Beach, FL 33160
305.792.0015 305.931.0279 info@absolute-idea.com

SEAL

KEN GARDNER
FL LA 1569

To the best of my knowledge, the plans and specifications comply with the applicable building codes and the applicable professional standards as determined by the local authority in accordance with the relevant regulations and codes.

Professionals

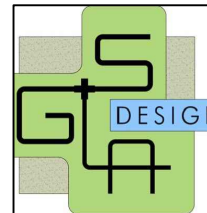

| REV. | DATE | DESCRIPTION |
|------|------------|------------------|
| 01 | XX-XX-2024 | D.R.C. SUBMITTAL |
| | | |
| | | |
| | | |
| | | |
| | | |
| | | |
| | | |

ALL MEASUREMENTS MUST BE VERIFIED BEFORE BEGINNING THE WORKS. NO MEASUREMENTS ARE TO BE SCALED DIRECTLY FROM THIS DRAWING.

Key section

PROGRESS SET

Client

VERA FUND
NICK POLYUSHKIN
& YURI KHARITONENKOV
TEL: 305.833.3303

Project

1600 S FEDERAL HIGHWAY
(MIXED-USE PROJECT)
1600 SOUTH FEDERAL HIGHWAY,
POMPANO BEACH, FL 33062

Title

IRRIGATION PLAN
GROUND FLOOR

| | |
|------------------------------|--------------------------------|
| Drawn GS LA | Field LANDSCAPE ARCH |
| Verified KG | Scale as shown |
| Approved KG | Date 10-09-2024 |
| Project Manager KG | Dwg. no. L-303 |
| Project 24-838 | |

DRC

PZ24-12000027

04/16/2025